

FOUNTAIN PAJOT ASTREA 42

NARNIA (2021)

Katamarán Fountaine Pajot Astrea 42 NARNIA, rok spuštění na vodu 2021 kotví v marině Athens, Alimos marina, Athens area/Saronic/Peloponese, Řecko. Počet kajut: 3 + 2, může ubytovat celkem: 6 + 2 + 2 a má toalet: 3. Povlečení a kuchyňské vybavení jsou zahrnuty v ceně.

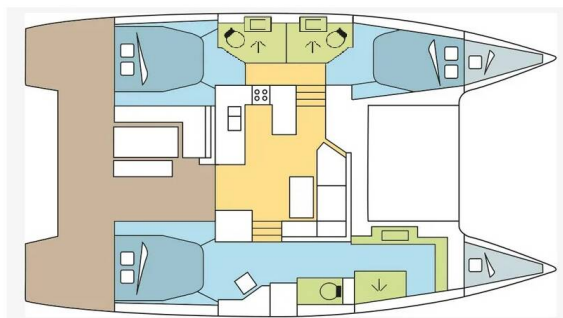

YACHT SPECIFICATIONS

Marína	Jachta ID	Značka
Athens, Alimos marina, Řecko	12103	Fountaine Pajot
Název jachty	Rok výroby	Délka
NARNIA	2021	41 ft
Kabiny	Lůžka	Maximální počet osob
3 + 2	6 + 2 + 2	10
WC	Motor	Palivová nádrž
3	2 x 50 HP	470 l



WEBSITE
www.plujeme.cz



TELEFON
+420 720 755 085



MOBILE
+420 777 170 276



E-MAIL
info@plujeme.cz



PLUJEME RÁDI S.R.O.
Dlouhá 730/35, 11000 Praha 1 – Staré Město, Česká republika

STANDARDNÍ VYBAVENÍ JACHTY

Bezpečnost	VHF rádio
Elektronika	Generátor, Invertor, Klimatizace, Solární panely, Watermaker – Odsolovač vody, WC pumpa, Zásuvky 12V
Interiér	Convertible table in salon, Ventilátory v kajutách
Kuchyňka	Lednička, Trouba, Trouba
Navigace	Autopilot, GPS mapový plotter – kokpit, Hloubkoměr, Rychloměr (Speed log), Wind instrument/Anemometer
Paluba	Bimini, Davit, Elektrický kotevní vrátek, Koupací žebřík, Lednička v kokpitě, Lodní můstek / lávka, Nafukovací člun, Přívěsný motor, Stoleček v kokpitě, Venkovní sprcha na zádi
Plachty	Elektrické navijáky/vinšny, Lazy bag, Lazy jacks, Self tailing vinšna
Pohodlí	Polštáře do kokpitu
Zábava	Fusion radio, Venkovní reproduktory



WEBSITE

www.plujeme.cz



E-MAIL

info@plujeme.cz



TELEFON

+420 720 755 085



MOBILE

+420 777 170 276



PLUJEME RÁDI S.R.O.

Dlouhá 730/35, 11000 Praha 1 – Staré Město, Česká republika

SLUŽBY

VYBRANÉ SLUŽBY	POVINNÉ	TYP PLATBY	CENA
Manipulační poplatky (Platba předem) Sezóna: 2026.	Ano	za rezervaci	20,00 €
Poplatek za přípravu jachty (Platba předem) Sezóna: 2026. INCLUDED: starter pack – (1 gallon water or 4 bottles of 1.5L, 1 bottle of disinfectant, 1 small bottle of washing up liquid, 1 dish cloth, 1 sponge, garbage bags, 1 roll of paper towels, 1 box of matches, 1 roll of toilet paper in each head) // final cleaning // 1 set of bed sheets / cabin & 1 set of towels / pax, dinghy, outboard engine & initial supply of fuel, gas and water tanks // DYC assistance guarantee // 1st & last night in the marina // NOT INCLUDED: refuelling, gas & water consumption at end of charter, taxes if any, handling fees & additional equipment deposit.	Ano	za rezervaci	355,00 €
Dřívější nalodění (Platba předem) Sezóna: 2026. EB (boat only) - 13:00h, starting time of boat's delivery // limited number of early boardings on same departure day	Ne	za rezervaci	340,00 €
Dřívější nalodění (Platba předem) Sezóna: 2026. EB + extra fee skipper - 13:00h, starting time of boat's delivery // limited number of early boardings on same departure day	Ne	za rezervaci	470,00 €
Dřívější nalodění (Platba předem) Sezóna: 2026. EB + extra fee Skipper & Hostess - 13:00h, starting time of boat's delivery // limited number of early boardings on same departure day	Ne	za rezervaci	580,00 €
Extra sada prádla (vyberte si kolik) (Platba předem) Sezóna: 2026. Extra set of linen : 15 € 1 extra set of linen (2 sheets & 2 pillow case) - to be updated manually	Ne	za rezervaci	15,00 €
Extra set of towels (choose how many) (Platba předem) Sezóna: 2026. Extra set of towels: 10 € 1 extra set of towels (1 face & 1 bath towel) - to be updated manually	Ne	za rezervaci	10,00 €
extra úklid (Platba předem) Sezóna: 2026. Optional Additional cleaning	Ne	za rezervaci	310,00 €

Hosteska/kuchař (Platba předem)	Ne	za noc	195,00 €
Sezóna: 2026. + provisioning, Crew on board must have their own toilets/ showers. If either a skipper or a hostess/cook is on board, 1 double cabin will be required for him/her. If both a skipper and a hostess/cook are on board, 1 double cabin and 1 forepeak cabin will be required for them. Exceptions exists for specific layouts, Sales Agents will provide more details about the different boat models			
Hosteska/kuchař (Platba předem)	Ne	za noc	195,00 €
Sezóna: 2026. + provisioning, Crew on board must have their own toilets/ showers. If either a skipper or a hostess/cook is on board, 1 double cabin will be required for him/her. If both a skipper and a hostess/cook are on board, 1 double cabin and 1 forepeak cabin will be required for them. Exceptions exists for specific layouts, Sales Agents will provide more details about the different boat models			
Hosteska/kuchař (Platba předem)	Ne	za noc	215,00 €
Sezóna: 2026. + provisioning, Crew on board must have their own toilets/ showers. If either a skipper or a hostess/cook is on board, 1 double cabin will be required for him/her. If both a skipper and a hostess/cook are on board, 1 double cabin and 1 forepeak cabin will be required for them. Exceptions exists for specific layouts, Sales Agents will provide more details about the different boat models			
Kapitán (Platba předem)	Ne	za noc	210,00 €
Sezóna: 2026. + provisioning, Crew on board must have their own toilets/ showers. If either a skipper or a hostess/cook is on board, 1 double cabin will be required for him/her. If both a skipper and a hostess/cook are on board, 1 double cabin and 1 forepeak cabin will be required for them. Exceptions exists for specific layouts, Sales Agents will provide more details about the different boat models			
Kapitán (Platba předem)	Ne	za noc	210,00 €
Sezóna: 2026. + provisioning, Crew on board must have their own toilets/ showers. If either a skipper or a hostess/cook is on board, 1 double cabin will be required for him/her. If both a skipper and a hostess/cook are on board, 1 double cabin and 1 forepeak cabin will be required for them. Exceptions exists for specific layouts, Sales Agents will provide more details about the different boat models			
Kapitán (Platba předem)	Ne	za noc	230,00 €
Sezóna: 2026. + provisioning, Crew on board must have their own toilets/ showers. If either a skipper or a hostess/cook is on board, 1 double cabin will be required for him/her. If both a skipper and a hostess/cook are on board, 1 double cabin and 1 forepeak cabin will be required for them. Exceptions exists for specific layouts, Sales Agents will provide more details about the different boat models			
Plná penze 1-3 osoby (počet hostů aktualizujte ručně) (Platba předem)	Ne	per guest/day	75,00 €
Sezóna: 2026. only available if cook is booked on board as the cook will do the provisioning based on client's preference. Includes breakfast, lunch & dinner + the crew's food. Does not included alcoholic drinks			

Plná penze 4-6 osob (počet hostů aktualizujte ručně) (Platba předem) Sezóna: 2026. only available if cook is booked on board as the cook will do the provisioning based on client's preference. Includes breakfast, lunch & dinner + the crew's food. Does not included alcoholic drinks	Ne	per guest/day	60,00 €
Plná penze 7-12 osob (počet hostů bude aktualizován ručně) (Platba předem) Sezóna: 2026. only available if cook is booked on board as the cook will do the provisioning based on client's preference. Includes breakfast, lunch & dinner + the crew's food. Does not included alcoholic drinks	Ne	per guest/day	55,00 €
Pojištění kauce (Platba předem) Sezóna: 2026. Damage waiver limits your liability to the reduced Security Deposit . Mandatory when skipper is added. Price is per night of the charter (minimum value of 7 nights & a maximum value of 21 nights). Not applicable for 4+ weeks charters , nor Regattas/Races.	Ne	za noc	50,00 €
Polopenze 1-3 osoby (počet hostů aktualizovat ručně) (Platba předem) Sezóna: 2026. only available if cook is booked on board as the cook will do the provisioning based on client's preference. Includes breakfast & lunch OR dinner + the crew's food. Does not included alcoholic drinks	Ne	per guest/day	60,00 €
Polopenze 4-6 osob (počet hostů aktualizujte ručně) (Platba předem) Sezóna: 2026. only available if cook is booked on board as the cook will do the provisioning based on client's preference. Includes breakfast & lunch OR dinner + the crew's food. Does not included alcoholic drinks	Ne	per guest/day	50,00 €
Polopenze 7-12 osob (počet hostů aktualizujte ručně) (Platba předem) Sezóna: 2026. only available if cook is booked on board as the cook will do the provisioning based on client's preference. Includes breakfast & lunch OR dinner + the crew's food. Does not included alcoholic drinks	Ne	per guest/day	45,00 €
Příplatek za kapitána v přídovém peaku a/nebo se sdílenou koupelnou (Platba předem) Sezóna: 2026. To be added with Skipper only ; Can be added for new bookings only confirmed after 21/05/2026 ; replaces skipper requirement to have their own toilet/shower. Guests must be aware that they'll need to give access to toilet/shower.	Ne	za noc	50,00 €
Příplatek za regatu (Platba předem) Sezóna: 2026. A special race deposit need to be doubled manually once the regatta surcharge is added.	Ne	za rezervaci	0,00 €
Spotřeba elektřiny a vody v přístavech (Platba na základně) Sezóna: 2026. Electric & Water consumption based on 2 nights on our dock (base will confirm the amount to pay locally depending on nights spent on dock)	Ne	za rezervaci	28,00 €

Transfer (Platba předem)	Ne	one-way	81,00 €
Sezóna: 2026. OW - Athens airport / Base 1 to 3 Pax - For transfers during hours 21:00-06:00h and bank holidays price should be raised by 30€ one-way, or 60€ round trip			
Transfer (Platba předem)	Ne	one-way	147,00 €
Sezóna: 2026. OW - Athens airport / Base 4 to 8 Pax - For transfers during hours 21:00-06:00h and bank holidays price should be raised by 30€ one-way, or 60€ round trip			
Transfer (Platba předem)	Ne	one-way	162,00 €
Sezóna: 2026. OW - Athens airport / Base 9 to 17 Pax - For transfers during hours 21:00-06:00h and bank holidays price should be raised by 30€ one-way, or 60€ round trip			
WI-FI Internet na lodi (Platba předem)	Ne	za týden	50,00 €
Sezóna: 2026. unlimited data			
Změna posádky (Platba předem)	Ne	za rezervaci	250,00 €
Sezóna: 2026. Any crew change during the charter is subject to € 250.- additional cost. The charge includes administration cost, change of bed linen and towels and one night at DYC ponton (marina fee included only if the same base than start base). It doesn't include cleaning, nor new transit log where applicable.			



WEBSITE

www.plujeme.cz



TELEFON

+420 720 755 085



MOBILE

+420 777 170 276



E-MAIL

info@plujeme.cz



PLUJEME RÁDI S.R.O.

Dlouhá 730/35, 11000 Praha 1 – Staré Město, Česká republika

DODATEČNÉ DOPLŇKY

DOPLŇKY	POVINNÉ	TYP PLATBY	CENA
Bezpečnostní síť (Platba předem) Sezóna: 2026. net is supplied but not installed - Platba předem	Ne	za rezervaci	250,00 €
Outboard engine 8 & 9,8 HP (Platba předem) Sezóna: 2026. Subject to Availability ; 8 & 9.8hp. Dinghy not suitable in any case for waterski or wakeboard. - Platba předem	Ne	za den	35,00 €
Stand up paddle (SUP) (Platba předem) Sezóna: 2026. Price per day - Platba předem	Ne	za noc	15,00 €



WEBSITE

www.plujeme.cz



E-MAIL

info@plujeme.cz



TELEFON

+420 720 755 085



MOBILE

+420 777 170 276



PLUJEME RÁDI S.R.O.

Dlouhá 730/35, 11000 Praha 1 – Staré Město, Česká republika

CENA A DOSTUPNOST

06.06. - 13.06.2026 4.875 € 5.735 €	13.06. - 20.06.2026 5.525 € 6.500 €	20.06. - 27.06.2026 5.542 € 6.520 €	27.06. - 04.07.2026 NEDOSTUPNÉ
04.07. - 11.07.2026 NEDOSTUPNÉ	11.07. - 18.07.2026 5.355 € 6.300 €	18.07. - 25.07.2026 5.808 € 6.830 €	25.07. - 01.08.2026 NEDOSTUPNÉ
01.08. - 08.08.2026 7.034 € 8.275 €	08.08. - 15.08.2026 7.034 € 8.275 €	15.08. - 22.08.2026 7.034 € 8.275 €	22.08. - 29.08.2026 5.614 € 6.605 €
29.08. - 05.09.2026 5.614 € 6.605 €	05.09. - 12.09.2026 6.256 € 7.360 €	12.09. - 19.09.2026 5.963 € 7.015 €	19.09. - 26.09.2026 6.579 € 7.310 €
26.09. - 03.10.2026 5.936 € 6.595 €	03.10. - 10.10.2026 4.487 € 4.985 €	10.10. - 17.10.2026 4.122 € 4.580 €	17.10. - 24.10.2026 3.807 € 4.230 €
24.10. - 31.10.2026 3.627 € 4.030 €	31.10. - 07.11.2026 NEDOSTUPNÉ	07.11. - 14.11.2026 2.637 € 2.930 €	15.11. - 31.12.2098 NEDOSTUPNÉ



WEBSITE
www.plujeme.cz



E-MAIL
info@plujeme.cz



TELEFON
+420 720 755 085



PLUJEME RÁDI S.R.O.
Dlouhá 730/35, 11000 Praha 1 – Staré Město, Česká republika



MOBILE
+420 777 170 276