

# BALI 4.1

ZENA (2019)

**Katamarán Bali 4.1 ZENA**, rok spuštění na vodu **2019** kotví v maríně **Seychelles, Praslin, Mahé (Seychely), Seychely** .

Počet kajut: **3 + 1** , může ubytovat celkem: **6 + 1** a má toalet: **2** .

Povlečení a kuchyňské vybavení jsou zahrnuty v ceně.

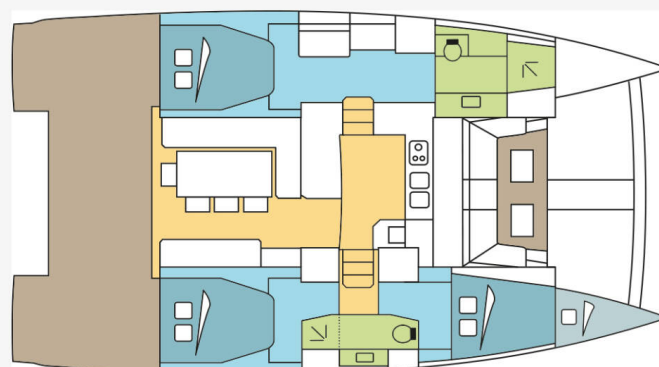

## YACHT SPECIFICATIONS

Marína <b>Seychelles, Praslin, Seychely</b>	Jachta ID <b>12080</b>	Značka <b>Catana</b>
Název jachty <b>ZENA</b>	Rok výroby <b>2019</b>	Délka <b>41 ft</b>
Kabiny <b>3 + 1</b>	Lůžka <b>6 + 1</b>	Maximální počet osob <b>7</b>
WC <b>2</b>	Motor <b>2 x 40 HP</b>	Palivová nádrž <b>400 l</b>



**WEBSITE**  
[www.plujeme.cz](http://www.plujeme.cz)



**TELEFON**  
+420 720 755 085



**MOBILE**  
+420 777 170 276



**E-MAIL**  
[info@plujeme.cz](mailto:info@plujeme.cz)



**PLUJEME RÁDI S.R.O.**  
Dlouhá 730/35, 11000 Praha 1 – Staré Město, Česká republika

## STANDARDNÍ VYBAVENÍ JACHTY

Bezpečnost	<b>VHF rádio</b>
Elektronika	<b>Invertor, Solární panely, WC pumpa, Zásuvka 220V, Zásuvky 12V</b>
Kuchyňka	<b>Lednička, Mrazák, Trouba, Trouba</b>
Navigace	<b>Autopilot, Hloubkoměr, Radar, Wind instrument/Anemometer</b>
Paluba	<b>Bimini, Cockpit grill, Davit, Elektrický kotevní vrátek, Grill/Barbecue/Plancha, Koupací žebřík, Nafukovací člun, Stoleček v kokpitu</b>
Plachty	<b>Elektrické navijáky/vinšny, Lazy bag, Lazy jacks, Self tailing vinšna</b>
Pohodlí	<b>Polštáře do kokpitu</b>
Zábava	<b>Fusion radio, Venkovní reproduktory</b>

**WEBSITE**

[www.plujeme.cz](http://www.plujeme.cz)

**E-MAIL**

[info@plujeme.cz](mailto:info@plujeme.cz)

**TELEFON**

+420 720 755 085

**MOBILE**

+420 777 170 276

**PLUJEME RÁDI S.R.O.**

Dlouhá 730/35, 11000 Praha 1 – Staré Město, Česká republika





## SLUŽBY

VYBRANÉ SLUŽBY	POVINNÉ	TYP PLATBY	CENA
<b>Essentials pack</b> (Platba předem) <b>Sezóna: 2026 Exotic.</b> INCLUDED: Damage waiver (covering damages) with reduced security deposit addressed specifically to blocked toilets, unpaid fuel, lost equipment, unpaid fees & fines, and returning the boat in an extremely dirty state. // starter pack – (1 gallon water or 4 bottles of 1.5L, 1 bottle of disinfectant, 1 small bottle of washing up liquid, 1 dish cloth, 1 sponge, garbage bags, 1 roll of paper towels, 1 box of matches, 1 roll of toilet paper in each head)// final cleaning // 1 set of bed sheets & towels, dinghy, outboard engine & initial supply of fuel, gas and water tanks // DYC assistance guarantee // 1st & last night in the marina /// NOT INCLUDED: refuelling, gas & water consumption at end of charter, taxes if any, handling fees & additional equipment deposit.	Ano	za rezervaci	<b>780,00 €</b>
<b>Manipulační poplatky</b> (Platba předem) <b>Sezóna: 2026 Exotic.</b>	Ano	za rezervaci	<b>35,00 €</b>
<b>Poplatek za přípravu jachty</b> (Platba předem) <b>Sezóna: 2026 Exotic.</b> INCLUDED: starter pack – (1 gallon water or 4 bottles of 1.5L, 1 bottle of disinfectant, 1 small bottle of washing up liquid, 1 dish cloth, 1 sponge, garbage bags, 1 roll of paper towels, 1 box of matches, 1 roll of toilet paper in each head)// final cleaning // 1 set of bed sheets / cabin & 1 set of towels / pax, dinghy, outboard engine & initial supply of fuel, gas and water tanks // DYC assistance guarantee // 1st & last night in the marina // NOT INCLUDED: refuelling, gas & water consumption at end of charter, taxes if any, handling fees & additional equipment deposit.	Ano	za rezervaci	<b>395,00 €</b>
<b>The Tourism Environmental Sustainability Levy</b> (Platba na základně) <b>Sezóna: 2026 Exotic.</b> According to S.I. 52 of 2023 ENVIRONMENT PROTECTION ACT (ext. of Act 18 of 2016), a Seychelles compulsory levy of 100SCR per person/day (or equivalent Currency as per daily rate) is applied, payable at base. NOT applicable to citizens and residents of Seychelles, children of 12 years and below (visitors), and Dream Yacht crew. . (Price will be adjusted according to the crew list)	Ano	per guest/day	<b>6,67 €</b>
<b>Extra sada prádla (vyberte si kolik)</b> (Platba předem) <b>Sezóna: 2026 Exotic.</b> Extra set of linen : 15 € 1 set of linen (2 sheets & 2 pillow case) – to be updated manually	Ne	za rezervaci	<b>15,00 €</b>
<b>Extra set of towels (choose how many)</b> (Platba předem) <b>Sezóna: 2026 Exotic.</b> Extra set of towels: 10 € 1 set of towels (1 face & 1 bath towel) – to be updated manually	Ne	za rezervaci	<b>10,00 €</b>

<b>extra úklid (Platba předem)</b>	Ne	za rezervaci	<b>310,00 €</b>
<b>Sezóna: 2026 Exotic.</b> <i>Optional Additional cleaning</i>			
<b>Full board 1-4 (number of guests to update manually) (Platba předem)</b>	Ne	per guest/day	<b>60,00 €</b>
<b>Sezóna: 2026 Exotic.</b> <i>only available if cook is booked on board as the cook will do the provisioning based on client's preference. Includes breakfast, lunch &amp; dinner + the crew's food. Does not included alcoholic drinks</i>			
<b>Full board 5-12 pax (number of guests to update manually) (Platba předem)</b>	Ne	per guest/day	<b>55,00 €</b>
<b>Sezóna: 2026 Exotic.</b> <i>only available if cook is booked on board as the cook will do the provisioning based on client's preference. Includes breakfast, lunch &amp; dinner + the crew's food. Does not included alcoholic drinks</i>			
<b>Half board 1-4 (number of guests to update manually) (Platba předem)</b>	Ne	per guest/day	<b>50,00 €</b>
<b>Sezóna: 2026 Exotic.</b> <i>only available if cook is booked on board as the cook will do the provisioning based on client's preference. Includes breakfast &amp; lunch OR dinner + the crew's food. Does not included alcoholic drinks</i>			
<b>Half board 5-12 pax (number of guests to update manually) (Platba předem)</b>	Ne	per guest/day	<b>45,00 €</b>
<b>Sezóna: 2026 Exotic.</b> <i>only available if cook is booked on board as the cook will do the provisioning based on client's preference. Includes breakfast &amp; lunch OR dinner + the crew's food. Does not included alcoholic drinks</i>			
<b>Kapitán (Platba předem)</b>	Ne	za noc	<b>170,00 €</b>
<b>Sezóna: 2026 Exotic.</b> <i>+ provisioning, Crew on board must have their own toilets/showers. If either a skipper or a hostess/cook is on board, 1 double cabin will be required for him/her. If both a skipper and a hostess/cook are on board, 1 double cabin and 1 forepeak cabin will be required for them. Exceptions exists for specific layouts, Sales Agents will provide more details about the different boat models</i>			
<b>Kapitán (Platba předem)</b>	Ne	za noc	<b>170,00 €</b>
<b>Sezóna: 2026 Exotic.</b> <i>+ provisioning, Crew on board must have their own toilets/showers. If either a skipper or a hostess/cook is on board, 1 double cabin will be required for him/her. If both a skipper and a hostess/cook are on board, 1 double cabin and 1 forepeak cabin will be required for them. Exceptions exists for specific layouts, Sales Agents will provide more details about the different boat models</i>			
<b>Kapitán (Platba předem)</b>	Ne	za noc	<b>190,00 €</b>
<b>Sezóna: 2026 Exotic.</b> <i>+ provisioning, Crew on board must have their own toilets/showers. If either a skipper or a hostess/cook is on board, 1 double cabin will be required for him/her. If both a skipper and a hostess/cook are on board, 1 double cabin and 1 forepeak cabin will be required for them. Exceptions exists for specific layouts, Sales Agents will provide more details about the different boat models</i>			

<b>Kapitán+kuchař</b> (Platba předem)	Ne	za noc	<b>220,00 €</b>
<b>Sezóna: 2026 Exotic.</b> (for charters up to max 3 guests, one person works as a skipper and cook) + provisioning, Crew on board must have their own toilets/showers. If either a skipper or a hostess/cook is on board, 1 double cabin will be required for him/her. If both a skipper and a hostess/cook are on board, 1 double cabin and 1 forepeak cabin will be required for them. Exceptions exists for specific layouts, Sales Agents will provide more details about the different boat models.			
<b>Kapitán+kuchař</b> (Platba předem)	Ne	za noc	<b>220,00 €</b>
<b>Sezóna: 2026 Exotic.</b> (for charters up to max 3 guests, one person works as a skipper and cook) + provisioning, Crew on board must have their own toilets/showers. If either a skipper or a hostess/cook is on board, 1 double cabin will be required for him/her. If both a skipper and a hostess/cook are on board, 1 double cabin and 1 forepeak cabin will be required for them. Exceptions exists for specific layouts, Sales Agents will provide more details about the different boat models.			
<b>Kapitán+kuchař</b> (Platba předem)	Ne	za noc	<b>245,00 €</b>
<b>Sezóna: 2026 Exotic.</b> (for charters up to max 3 guests, one person works as a skipper and cook) + provisioning, Crew on board must have their own toilets/showers. If either a skipper or a hostess/cook is on board, 1 double cabin will be required for him/her. If both a skipper and a hostess/cook are on board, 1 double cabin and 1 forepeak cabin will be required for them. Exceptions exists for specific layouts, Sales Agents will provide more details about the different boat models.			
<b>Pojištění kauce</b> (Platba předem)	Ne	za noc	<b>60,00 €</b>
<b>Sezóna: 2026 Exotic.</b> Damage waiver limits your liability to the reduced Security Deposit . Mandatory when skipper is added. Price is per night of the charter ( minimum value of 7 nights & a maximum value of 21 nights) Not applicable for 4+ weeks charters , nor Regattas/Races.			
<b>Pomocník kapitána</b> (Platba předem)	Ne	za noc	<b>130,00 €</b>
<b>Sezóna: 2026 Exotic.</b> + provisioning			
<b>Příplatek za regatu</b> (Platba předem)	Ne	za rezervaci	<b>0,00 €</b>
<b>Sezóna: 2026 Exotic.</b> all the regattas apart of ASW (different regatta surcharge for ASW) // A special race deposit need to be doubled manually once the regatta surcharge is added.			
<b>Spotřeba elektřiny a vody v přístavech</b> (Platba na základně)	Ne	za rezervaci	<b>28,00 €</b>
<b>Sezóna: 2026 Exotic.</b> Electric & Water consumption based on 2 nights on our dock (base will confirm the amount to pay locally depending on nights spent on dock)			

<b>Starter pack</b> (Platba předem)	Ne	za rezervaci	<b>50,00 €</b>
<b>Sezóna: 2026 Exotic.</b> included in Essentials pack (The pack includes: 1 gallon water (or 4 bottles of 1.5L), 1 bottle of disinfectant, 1 small bottle of washing up liquid, 1 dish cloth, 1 sponge, garbage bags, 1 roll of paper towels, 1 box of matches, 1 roll of toilet paper in each head)			
<b>Steward/Cook</b> (Platba předem)	Ne	za noc	<b>145,00 €</b>
<b>Sezóna: 2026 Exotic.</b> + provisioning, a cabin or forepeak to sleep and access to a WC/Shower			
<b>Steward/Cook</b> (Platba předem)	Ne	za noc	<b>145,00 €</b>
<b>Sezóna: 2026 Exotic.</b> + provisioning, a cabin or forepeak to sleep and access to a WC/Shower			
<b>Steward/Cook</b> (Platba předem)	Ne	za noc	<b>160,00 €</b>
<b>Sezóna: 2026 Exotic.</b> + provisioning, a cabin or forepeak to sleep and access to a WC/Shower			
<b>Transfer</b> (Platba předem)	Ne	one-way	<b>15,00 €</b>
<b>Sezóna: 2026 Exotic.</b> OW - Jetty Terminal/base 1 to 4 pax			
<b>Transfer</b> (Platba předem)	Ne	one-way	<b>20,00 €</b>
<b>Sezóna: 2026 Exotic.</b> OW - Jetty Terminal/base 5 to 8 pax			
<b>Transfer</b> (Platba předem)	Ne	one-way	<b>29,00 €</b>
<b>Sezóna: 2026 Exotic.</b> OW - Jetty Terminal/base 9 to 12 pax			
<b>Transfer</b> (Platba předem)	Ne	okružní plavba	<b>78,00 €</b>
<b>Sezóna: 2026 Exotic.</b> RT - Praslin airport/base/airport 1 to 4 pax			
<b>Transfer</b> (Platba předem)	Ne	okružní plavba	<b>98,00 €</b>
<b>Sezóna: 2026 Exotic.</b> RT - Praslin airport/base/airport 5 to 8 pax			
<b>Transfer</b> (Platba předem)	Ne	okružní plavba	<b>118,00 €</b>
<b>Sezóna: 2026 Exotic.</b> RT - Praslin airport/base/airport 9 to 12 pax			
<b>Transfer</b> (Platba předem)	Ne	okružní plavba	<b>136,00 €</b>
<b>Sezóna: 2026 Exotic.</b> RT - Praslin airport/base/airport 13 to 16 pax			
<b>Závěrečný úklid</b> (Platba předem)	Ne	za rezervaci	<b>310,00 €</b>
<b>Sezóna: 2026 Exotic.</b> included in Essentials pack			

<b>Závěrečný úklid</b> (Platba předem)	Ne	za rezervaci	<b>310,00 €</b>
<b>Sezóna: 2026 Exotic.</b> included in Essentials pack			
 <b>WEBSITE</b> www.plujeme.cz	 <b>TELEFON</b> +420 720 755 085	 <b>MOBILE</b> +420 777 170 276	
 <b>E-MAIL</b> info@plujeme.cz	 <b>PLUJEME RÁDI S.R.O.</b> Dlouhá 730/35, 11000 Praha 1 – Staré Město, Česká republika		



## DODATEČNÉ DOPLŇKY

DOPLŇKY	POVINNÉ	TYP PLATBY	CENA
<b>Bezpečnostní síť</b> (Platba předem) <b>Sezóna: 2026 Exotic.</b> net is supplied but not installed - Platba předem	Ne	za rezervaci	<b>250,00 €</b>
<b>Kayak single</b> (Platba předem) <b>Sezóna: 2026 Exotic.</b> price per day - Platba předem	Ne	za noc	<b>15,00 €</b>
<b>Kayak tandem</b> (Platba předem) <b>Sezóna: 2026 Exotic.</b> price per day - Platba předem	Ne	za noc	<b>15,00 €</b>
<b>Rybářské vybavení</b> (Platba předem) <b>Sezóna: 2026 Exotic.</b> Additional deposit 100 EUR (subject to availability) - Platba předem	Ne	za den	<b>15,00 €</b>
<b>Stand up paddle (SUP)</b> (Platba předem) <b>Sezóna: 2026 Exotic.</b> Price per day - Platba předem	Ne	za noc	<b>15,00 €</b>
<b>Wi-Fi Internet</b> (Platba předem) <b>Sezóna: 2026 Exotic.</b> Wifi Unlimited - Platba předem	Ne	za noc	<b>12,00 €</b>

**WEBSITE**[www.plujeme.cz](http://www.plujeme.cz)**E-MAIL**[info@plujeme.cz](mailto:info@plujeme.cz)**TELEFON**

+420 720 755 085

**MOBILE**

+420 777 170 276

**PLUJEME RÁDI S.R.O.**

Dlouhá 730/35, 11000 Praha 1 - Staré Město, Česká republika

## CENA A DOSTUPNOST

25.04. - 02.05.2026 NEDOSTUPNÉ	02.05. - 09.05.2026 NEDOSTUPNÉ	09.05. - 23.05.2026 NEDOSTUPNÉ	23.05. - 30.05.2026 NEDOSTUPNÉ
30.05. - 06.06.2026 2.808 € 3.510 €	06.06. - 13.06.2026 2.520 € 3.150 €	13.06. - 20.06.2026 2.520 € 3.150 €	20.06. - 27.06.2026 2.520 € 3.150 €
27.06. - 04.07.2026 2.520 € 3.150 €	05.07. - 10.07.2026 NEDOSTUPNÉ	11.07. - 18.07.2026 2.512 € 3.140 €	18.07. - 25.07.2026 2.724 € 3.405 €
25.07. - 01.08.2026 2.724 € 3.405 €	05.08. - 13.08.2026 NEDOSTUPNÉ	19.08. - 30.08.2026 NEDOSTUPNÉ	05.09. - 12.09.2026 NEDOSTUPNÉ
12.09. - 19.09.2026 NEDOSTUPNÉ	21.09. - 02.10.2026 NEDOSTUPNÉ	06.10. - 11.10.2026 NEDOSTUPNÉ	17.10. - 24.10.2026 5.060 €
24.10. - 31.10.2026 4.221 € 4.690 €	31.10. - 07.11.2026 4.928 € 5.475 €	07.11. - 14.11.2026 4.919 € 5.465 €	17.11. - 08.12.2026 NEDOSTUPNÉ



**WEBSITE**  
www.plujeme.cz



**E-MAIL**  
info@plujeme.cz



**TELEFON**  
+420 720 755 085



**PLUJEME RÁDI S.R.O.**  
Dlouhá 730/35, 11000 Praha 1 – Staré Město, Česká republika



**MOBILE**  
+420 777 170 276

## CENA A DOSTUPNOST

12.12. - 19.12.2026 <b>2.696 €</b> 2.995 €	19.12. - 26.12.2026 <b>3.753 €</b> 4.170 €	02.01. - 09.01.2027 <b>4.086 €</b> 4.540 €	09.01. - 16.01.2027 <b>3.420 €</b> 3.800 €
22.01. - 29.01.2027 NEDOSTUPNÉ	30.01. - 06.02.2027 <b>3.911 €</b> 4.345 €	06.02. - 13.02.2027 <b>4.401 €</b> 4.890 €	13.02. - 20.02.2027 <b>4.527 €</b> 5.030 €
20.02. - 27.02.2027 <b>4.649 €</b> 5.165 €	27.02. - 06.03.2027 <b>4.649 €</b> 5.165 €	06.03. - 13.03.2027 <b>4.887 €</b> 5.430 €	13.03. - 20.03.2027 <b>4.887 €</b> 5.430 €
20.03. - 27.03.2027 <b>4.887 €</b> 5.430 €	27.03. - 03.04.2027 <b>5.049 €</b> 5.610 €	03.04. - 10.04.2027 <b>5.049 €</b> 5.610 €	10.04. - 17.04.2027 <b>5.049 €</b> 5.610 €
17.04. - 24.04.2027 <b>5.049 €</b> 5.610 €	24.04. - 01.05.2027 <b>4.451 €</b> 4.945 €	02.05. - 31.12.2098 NEDOSTUPNÉ	



WEBSITE

[www.plujeme.cz](http://www.plujeme.cz)



E-MAIL

[info@plujeme.cz](mailto:info@plujeme.cz)



TELEFON

+420 720 755 085



MOBILE

+420 777 170 276



PLUJEME RÁDI S.R.O.

Dlouhá 730/35, 11000 Praha 1 – Staré Město, Česká republika